

SKYLINE DFW EXHIBITS AND GRAPHICS 1100 AVENUE S SUITE 900 GRAND PRAIRIE, TEXAS 75050

NOTICE:
 THESE DOCUMENTS AND RELATED CONTRACT DOCUMENTS WERE PREPARED SPECIFICALLY FOR THE CONSTRUCTION LOCATION AT:
 1100 AVENUE S SUITE 900 GRAND PRAIRIE, TEXAS.

ALL PLANS, DETAILS, SCHEDULES, SPECIFICATIONS AND OTHER CONTRACT DOCUMENTS ARE COPYRIGHTED BY LAMBDIN ARCHITECTS, 2008, AND ARE PROTECTED BY ALL APPLICABLE COPYRIGHT LAWS, AND THEIR USE, IN WHOLE OR IN PART, FOR ANY OTHER BUILDING OR CONSTRUCTION PROJECT IS STRICTLY PROHIBITED.

THE SEAL OF THE ARCHITECT AND ENGINEERS AFFIXED TO THESE CONTRACT DOCUMENTS ARE PROTECTED BY SPECIFIC LICENSING REGULATIONS OF THE STATE OF TEXAS, AND THEIR USE BY ANY OTHER PERSON, FOR ANY OTHER CONSTRUCTION PROJECT, OR FOR ANY OTHER PURPOSE IS STRICTLY FORBIDDEN.

CONTRACTOR SHALL VERIFY ALL EXISTING CONDITIONS AND DIMENSIONS PRIOR TO CONSTRUCTION. THE LIMITS OF THE ARCHITECTURAL LIABILITY NOT TO EXCEED FEE PAID FOR SERVICES AND PLANS.

CONSTRUCTION TO MEET ALL FEDERAL, STATE AND LOCAL CODES INCLUDING STATE ENERGY CODE REQUIREMENTS.

THE TEXAS BOARD OF ARCHITECTURAL EXAMINERS HAS JURISDICTION OVER COMPLAINTS REGARDING THE PROFESSIONAL PRACTICES OF PERSONS REGISTERED AS ARCHITECTS IN TEXAS.

TEXAS BOARD OF ARCHITECTURAL EXAMINERS
 P.O. BOX 12337
 AUSTIN, TEXAS 78711-2337
 TELEPHONE: 512.305.9000
 FAX: 512.305.8900

THE CONSTRUCTION OF THIS PROJECT SHALL CONFORM TO ALL APPLICABLE LOCAL, STATE AND FEDERAL CODES, INCLUDING THE FOLLOWING:
 2003 INTERNATIONAL BUILDING CODE
 2003 INTERNATIONAL MECHANICAL CODE
 2003 INTERNATIONAL PLUMBING CODE
 2005 NATIONAL ELECTRICAL CODE
 2003 NATIONAL FIRE CODE
 2003 INTERNATIONAL ENERGY CODE
 AMERICANS WITH DISABILITIES ACT

AREA CALCULATIONS	
BUSINESS GROUP B CONSTRUCTION TYPE I A ALLOWABLE AREA ALLOWABLE HEIGHT	UL UL
FIRST FLOOR OFFICE WAREHOUSE	9,120 S.F. 23,260 S.F.
SECOND FLOOR OFFICE	4,280 S.F.
TOTAL	36,660 S.F.

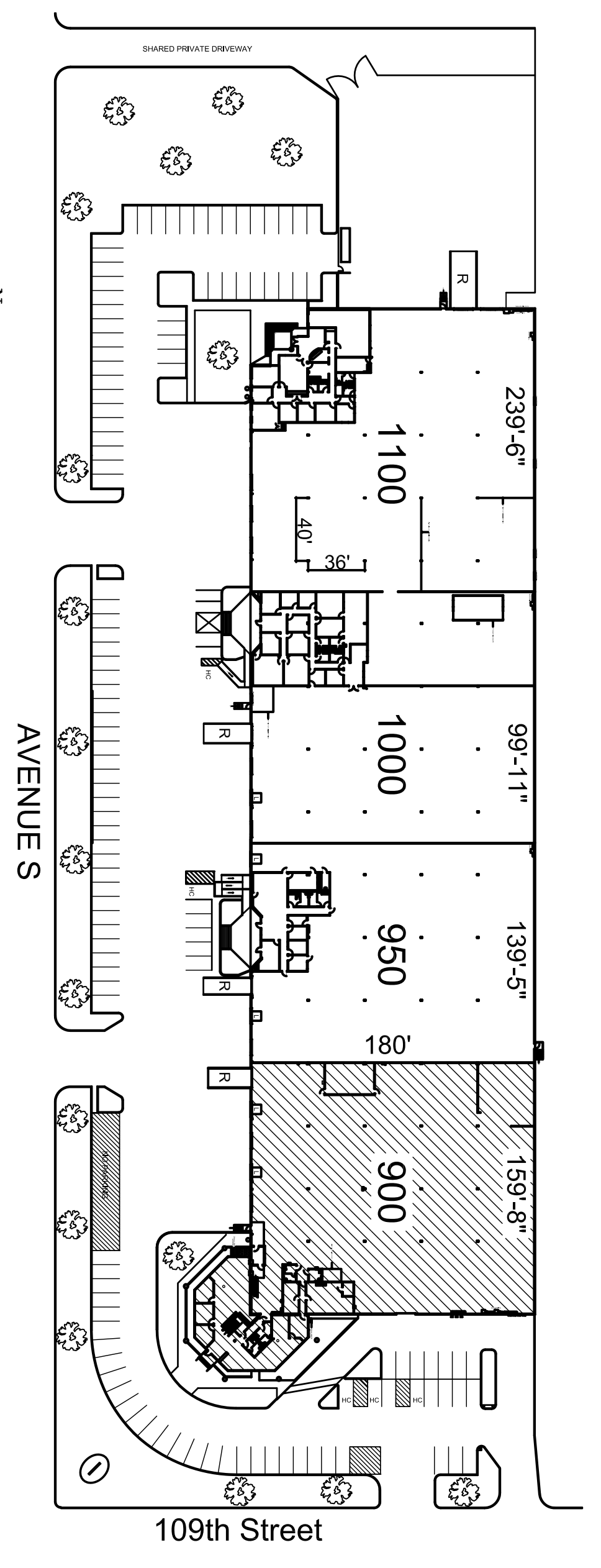

N
E
S
W
N.T.S.
SUITE 900

INDEX OF DRAWINGS	
COVER SHEET	
A-1.0	GENERAL NOTES
A-2.1	FIRST FLOOR DEMOLITION PLAN
A-2.2	SECOND FLOOR DEMOLITION PLAN
A-3.1	FIRST FLOOR PLAN
A-3.2	ENLARGED FIRST FLOOR PLAN
A-4.1	SECOND FLOOR PLAN
A-4.2	ENLARGED SECOND FLOOR PLAN
A-5.0	SCHEDULES
A-6.0	ACCESSIBILITY

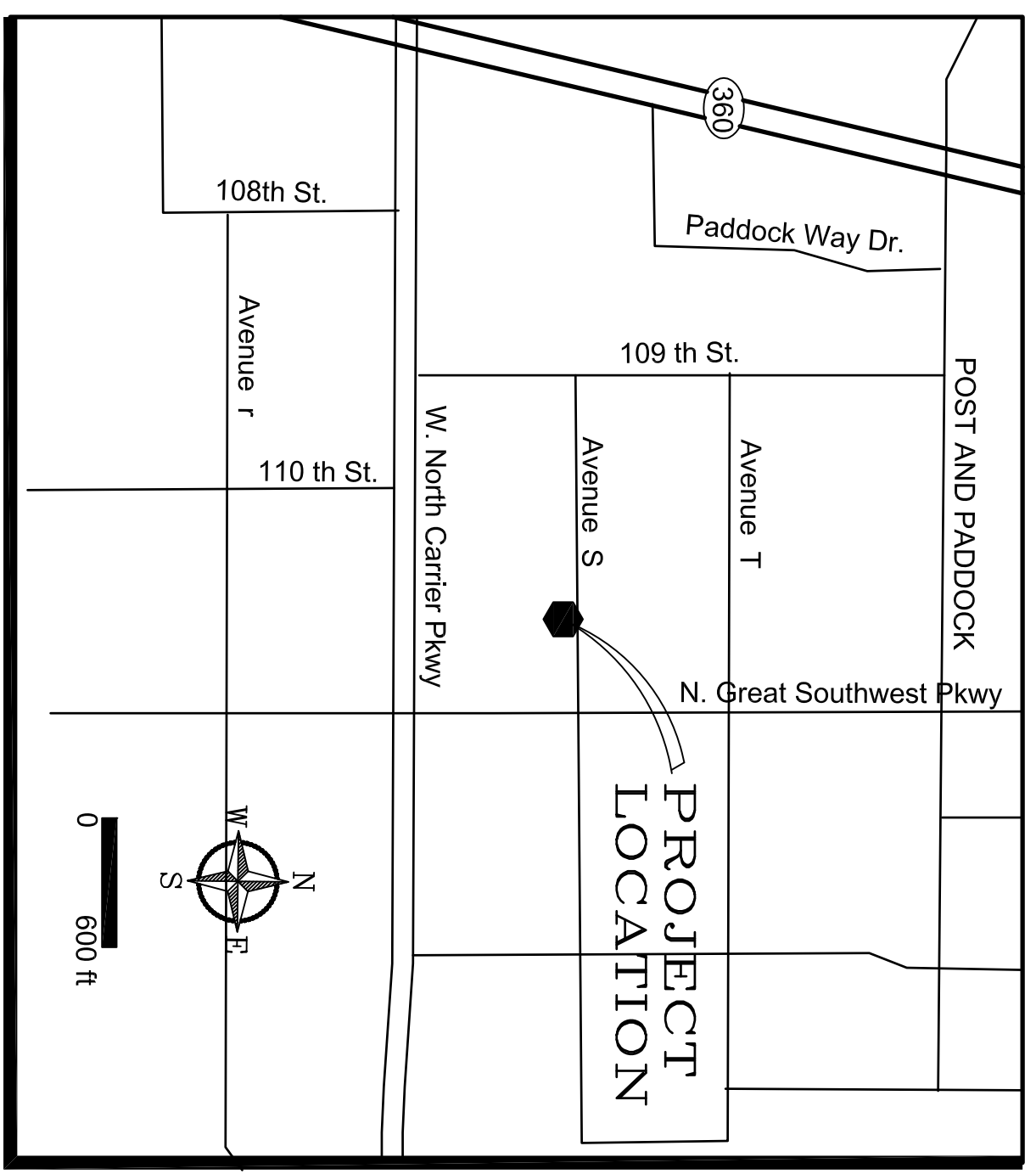

VICINITY MAP

LAMBDIN ARCHITECTS AND DESIGN
 ARCHITECTURAL PLANNING
 8000 CAMINO DR.
 N. RICHLAND HILLS, TEXAS 76180
 www.lambdinarchitects.com
 817-691-6621

FIRST INDUSTRIAL REALTY TRUST, INC
 7335 Airport Freeway
 Richland Hills, Texas 76118
 T: (817) 595-4177 F: (817) 595-4204
 www.firstindustrial.com

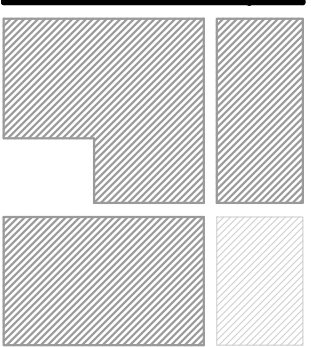

FIRST INDUSTRIAL REALTY TRUST