

ABBREVIATIONS

NOTE: ALL ABBREVIATIONS ARE GENERAL AND MAY NOT NECESSARILY APPEAR WITHIN THIS SET OF DRAWINGS.

AAV	AUTOMATIC AIR VENT	ENAM	ENAMEL	OA	OVERALL
AB	ANCHOR BOLT	ENT	ENTRANCE	O.C.	ON CENTER (S)
ABV	ABOVE	EQ	EQUAL	OD	OUTSIDE DIAMETER
AC	AIR CONDITIONING	EQUIP	EQUIPMENT	OTB	NOT USED
ACC	ACCESS	EST	ESTIMATE	OPNG	OPENING
ACOUS	ACOUSTICAL	EWC	ELECTRIC WATER COOLER	OPP	OPPOSITE
ACT	ACOUSTICAL TILE (NEW)	EXF	EXHAUST FAN	P	PAINT (NEW)
AD	ACCESS DOOR	EXH	EXHAUST	PFB	PREFABRICATE (D)
ADJ	ADJUSTABLE	EXT	EXTERIOR	PL	PLATE
ADJC	ADJACENT	EXIST	EXISTING	PLAM	PLASTIC LAMINATE
AFF	ABOVE FINISHED FLOOR	EXP	EXPOSED	PLAS	PLASTER
AHU	AIR HANDLING UNIT	FA	FIRE ALARM	PLY.	PLYWOOD
ALT	ALTERNATE	FAB	FABRIC	PM	PRESSED METAL
ALUM	ALUMINUM	FAS	FASTEN, FASTENER	PNB	PANIC BAR
ANC	ANCHOR, ANCHORAGE	FBO	FURNISHED BY OTHERS	POL	POLISHED
ANOD	ANODIZED	FDN	FOUNDATION	PROP	PROPERTY
AP	ACCESS PANEL	F/CONC	FACE OF CONCRETE	PRT	PRESERVATIVE TREATED
APPROX	APPROXIMATE	FD	FLOOR DRAIN	PTD	PAINTED
ARCH	ARCHITECT (URAL)	FF	FINISHED FLOOR /FACE	PTN	PARTITION
ASPH	ASPHALT	F/FIN	FACE OF FINISH	PTR	PAPER TOWEL RECEPTOR
AT	ASPHALT TILE	FE	FIRE EXTINGUISHER	PVC	POLYVINYL CHLORIDE
AUX	AUXILIARY	FEC	FIRE EXTINGUISHER CABINET	QT	QUARRY TILE
BBD	BULLETIN BOARD	FGL	FIBERGLASS	R	RISER
BD	BOARD	FHC	FIRE HOSE CABINET	RA	RETURN AIR
BEL	BELOW	FHS	FIRE HOSE STATION	Rad	RADIUS
BET	BETWEEN	FIN	FINISH (ED)	RB	RESILIENT BASE
BEV	BEVELED	FLUOR	FLUORESCENT	RD	ROOF DRAIN
BLDG	BUILDING	FLASH	FLASHING	RDC	ROOF DRAIN CONDUCTOR
BLK	BLOCK	FLX	FLEXIBLE	REF	REFERENCE
BLKG	BLOCKING	F/MAS	FACE OF MASONRY	REFL	REFLECT (ED), (IVE), (OR)
BM	BEAM	FPRFG	FIREPROOFING	REINF	REINFORCEMENT
BT	BOTTOM	FR	FIRE RESISTANT	REQD	REQUIRED
BRG	BEARING	FS	FACE OF STUDS	REV	REVISION (S), REVISED
BRG PL	BEARING PLATE	FSZ	FULL SIZE	RFG	ROOFING
BRK	BRICK	FT	FEET	RM	ROOM
BS	BOTH SIDES	FTG	FOOTING	RO	ROUGH OPENING
BUR	BUILT UP ROOFING	FURR	FURRED (ING)	S	SINK
BW	BOTH WAYS	FV	FIELD VERIFY	SCHED	SCHEDULE
C	CONDUIT	GA	GAGE, GAUGE	SCT	STRUCTURAL CLAY TILE
CAB	CABINET	GALV	GALVANIZED	STD	STANDARD
C.B.	CHALKBOARD	GB	GRAB BAR	SECT	SECTION
CC	CENTER TO CENTER	GC	GENERAL CONTRACTOR (OR)	SFGL	SAFETY GLASS
CCTV	CLOSED CIRCUIT TELEVISION	GFCI	GRAND FAULT CIRCUIT INTERRUPTER	SNT	SEALANT
CEM.	CEMENT	GL	GLASS, GLAZING	SQ	SQUARE
CER	CERAMIC	GVL	GRAVEL	SS	STAINLESS STEEL
CFL	COUNTERFLASHING	GWB	GYPSTUM WALL BOARD	STA	STATION
CG	CORNER GUARD	GYP.	GYPSTUM BOARD	STD	STANDARD
CIRC	CIRCUMFERENCE	GYP. BD.	GYPSTUM BOARD	STG	SEATING
CJ	CONSTRUCTION JOINT	HB	HOSE BIB	STL	STEEL
CK	CALK (ING)	HC	HOLLOW CORE	STO	STORAGE
CLG	CEILING	HDRE	HARDWARE	STRUCT	STRUCTURAL
CLOS	CLOSET	HDF	HIGH DENSITY FIBERBOARD	SUSP	SUSPENDED
CLR	CLEAR (ANCE)	HK	HOOK (S)	SYM	SYMMETRY (ICAL)
CLS	CLOSURE	HM	HOLLOW METAL	SYS	SYSTEM
CMU	CONCRETE MASONRY UNIT	HORIZ	HORIZONTAL	TBS	TO BE SELECTED
CO	CLEAN OUT	HP	HIGH POINT	TB	TACKBOARD
CPT	CARPET (ING)	HR	HANDRAIL	TC	TOP OF CURB
COL	COLUMN	HT	HEIGHT	TEL	TELEPHONE
COMP	COMPRESS (ED), (ION), (IBLE)	HTG	HEATING	TERR	TERRAZZO
CONC	CONCRETE	HVAC	HEATING/VENTILATING/AIR COND	T&G	TONGUE AND GROOVE
CONN	CONNECTION	ID	INSIDE DIAMETER	TH	THRESHOLD
CONST	CONSTRUCTION	IF	INSIDE FACE	THK	THICK (NESS)
CONT	CONTINUOUS OR CONTINUE	INCL	INCLUDE (D), (ING)	TKS	TACKSTRIP
CONTR	CONTRACT (OR)	INFO	INFORMATION	TLB	TOWEL BAR
CORR	CORRIDOR	INSUL	INSULATE (D), (ION)	TO	TOP OF
CR	CHROMIUM (PLATED)	INT	INTERIOR	TOL	TOLERANCE
CRT	CATHODE RAY TUBE	INV	INVERT	T.O.S	TOP OF STEEL
CT	CERAMIC TILE	JBOX	JUNCTION BOX	TPD	TOILET PAPER DISPENSER
CTR	COUNTER	JC	JANITOR'S CLOSET	TPTN	TOILET PARTITION
CTSK	COUNTERSINK	JT	JOINT	TS	TOP OF SLAB
D	DEEP	KIT	KITCHEN	TV	TELEVISION
DA	DOUBLEACTING	KO	KNOCKOUT	T.O.W.	TOP OF WALL
DEMO	DEMOLISH, DEMOLITION	KP	KICKPLATE	TYP	TYPICAL
DET	DETAIL	L	ANGLE (STEEL NOTATION)	UNF	UNFINISHED
DEPR	DEPRESSED	LAB	LABORATORY	UON	UNLESS OTHERWISE NOTED
DF	DRINKING FOUNTAIN	LAM	LAMINATE (D)	UR	URINAL
DIA	DIAMETER	LAV	LAVATORY	V	VENT
DIAG	DIAGONAL	LB	POUND	VB	VINYL BASE
DIM	DIMENSION	LL	LIVE LOAD	VCT	VINYL COMPOSITION TILE
DIV	DIVISION	LP	LOW POINT	VERT	VERTICAL
DL	DEAD LOAD	LT	LIGHT	VIN	VINYL
DMT	DEMOUNTABLE	LVR	LOUVER	VPB	VAPOR BARRIER
DN	DOWN	MAINT	MAINTENANCE	VT	VINYL TILE
DP	DAMPPOOFING	MAS	MASONRY	WVF	VINYL WALL FABRIC
DPR	DAMPER	MAT	MATERIAL (S)	W	WITH
DR	DOOR	MAX	MAXIMUM	WB	WOOD BASE
DS	DOWNSPOUT	MCB	METAL CORNER BEAD	WC	WATER CLOSET
DW	DUMBWAITER	MECH	MECHANIC (AL)	WD	WOOD
DWG	DRAWING	MED	MEDIUM	WG	WIRE GLASS
DWR	DRAWER	MFR	MANUFACTURE (ER)	WIN	WIRE MESH PARTITION
EA	EACH	MIN	MINIMUM	WIT	WITH OUT
EACT	ACOUSTICAL TILE (EXIST.)	MIR	MIRROR	WP	WEATHERPROOF
EB	EXPANSION BOLT	MISC	MISCELLANEOUS	WPF	WATERPROOFING
EG	EXTERIOR GRADE	MO	MASONRY OPENING	WPT	WORKING POINT
EG	EXTERIOR GRADE	MULL	MULLION	WSCT	WAINSCOT
EJ	EXPANSION JOINT	NIC	NOT IN CONTRACT	WR	WATER RESISTANT
EL	ELEVATION	NOM	NOMINAL	WWM	WELDED WIRE MESH
ELEC	ELECTRIC (AL)	NRC	NOISE REDUCTION COEFFICIENT	XFMR	TRANSFORMER
ELEV	ELEVATOR	NTS	NOT TO SCALE		
EMERG	EMERGENCY				
EMT	ELECTRICAL METALLIC TUBING				

LOCATION MAP

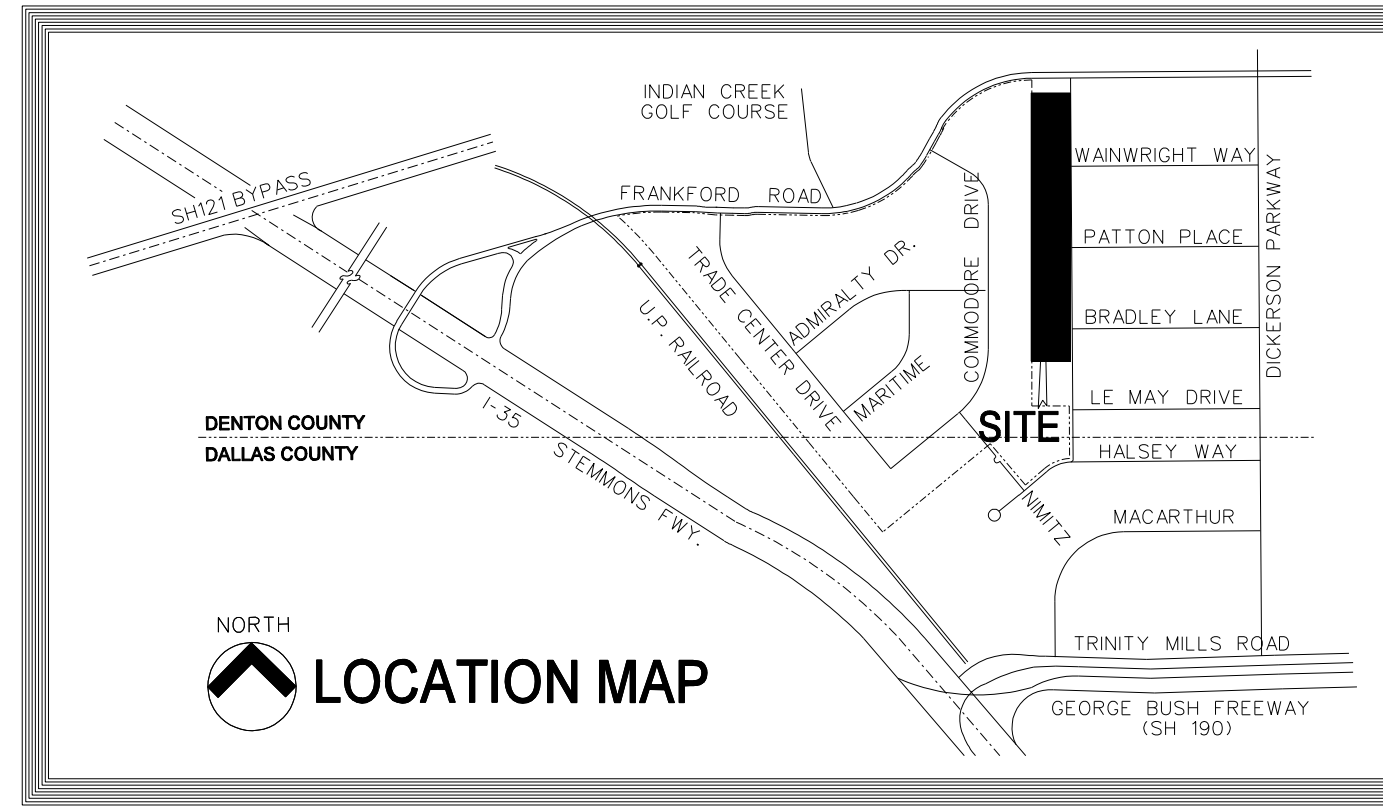

PROJECT DATA SUMMARY APPLIED WAREHOUSE LEASE

TOTAL BUILDING AREA	92,520 sf	PARKING DATA	
LEASE DATA			
OFFICE AREA	764 sf	PARKING REQUIRED	10 SPACES
WAREHOUSE AREA	17,160 sf		
TOTAL LEASE AREA	17,924 sf	TOTAL PARKING PROVIDED	10 SPACES

CODE DATA	
2006 IBC WITH AMENDMENTS	
OCCUPANCY	B, S-1 (NON SEPARATED USE)
CONSTRUCTION	IIB
100% ESFR SPRINKLERED	

ARCHITECTURAL SYMBOLS

100.00' ELEVATION OF ARCHITECTURAL ELEMENT

1 A1.0 DETAIL INDICATION

3 A2.0 SECTION INDICATION

3/A4.3 INTERIOR ELEVATION

P037 PANEL NUMBER

A WINDOW INDICATION

REVISION NUMBER

HANDICAPPED PARKING SYMBOL PAINTED ON PAVEMENT

FIRE EXT. CABINET

100 DOOR NUMBER

ROOM NAME

501 ROOM DESIGNATION

A WALL TYPE TAG

3 DENOTES KEY NOTE DESIGNATION

5/A1.0 DETAIL SECTION CUT

NOTE: SEE OTHER SPECIFIC SYMBOL LEGENDS ON EACH DRAWING WHERE OCCURS.

INDEX TO DRAWINGS

COVER	ARCHITECTURAL SYMBOLS AND PROJECT DATA
INDEX	Texas Accessibility Standards
TAS	ARCHITECTURAL
A1.0	OVERALL SITE PLAN/ BLDG. PLAN/ ENLARGED SITE ENTRY
A1.1	SITE DETAILS
A2.1	FLOOR PLAN/ WALL PARTITIONS
A2.2	ENLARGED OFFICE FLOOR PLAN INTERIOR ELEVATIONS, MILLWORK SECTIONS
A2.3	REFLECTED CEILING PLAN ELECTRICAL DATA PLAN & SCHEDULES

GENERAL NOTES

- The General Contractor will be responsible for the requirements identified in the keynotes (where used) It is intended that all keynotes are identified on the drawings. In some cases, a keynote may not be identified or located, but it will be the responsibility of the Contractor to notify the Architect of any omission in locating a listed keynote. All keynotes are to be construed as a requirement to do the work listed or described and if a keynote has not been located on the drawings, the Architect will do so for clarification. Some keynotes are not identified at each and every location, but it will be understood that repetitive work will require the same requirements of the keynote referenced in the same or similar circumstances in the project. The scope of the work will include all keynotes whether they are located on the drawings or not.
- All work shall comply with applicable codes, regulations, and ordinances having jurisdiction. The Contractor shall notify the Architect of any conflict between the drawings and governing codes prior to beginning of construction.
- The Contractor shall verify actual conditions prior to beginning construction. Notify the Architect of any discrepancies between drawings and actual conditions before proceeding with work.
- Under no circumstances shall any measurement be scaled from the drawings. Dimensions not indicated shall be clarified by the Architect prior to proceeding with work.
- All door frames are to be 4 inches from face of adjacent perpendicular drywall partition measured at the hinge side of the frame unless noted otherwise.
- All angles shown are 45 degrees unless otherwise noted.
- Refer to floor plan designation of all door swings to take precedence over door schedule and any submittal.

Drawn: checked: MARK W. PROSS date: 03/28/2008

ARGENT DEVELOPMENT BY ARGENT PROPERTY COMPANY, LTD. (214) 361-6090

PACK RAT, INC. PROSS DESIGN GROUP, INCORPORATED 5010 MacArthur Hill Road, Suite 1400, Dallas, Texas 75240 972/798-1400

job no 0812 sheet INDEX

03:54:03P IPW 04/01/2008 S:\0812 Pack Rat\Addendum\0812 INDEX.SHT © 2000 THIS DOCUMENT AND THE DESIGNS CONTAINED THEREIN REMAINS THE PROPERTY OF PROSS DESIGN GROUP, INC. AS AN INSTRUMENT OF PROFESSIONAL SERVICE, IT IS NOT TO BE USED IN WHOLE OR IN PART FOR ANY OTHER PURPOSE WITHOUT THE WRITTEN PERMISSION OF PROSS DESIGN GROUP.