

**SCOPE OF WORK:**  
REMODEL OF EXISTING OFFICE AREA

**LEASE SPACE: 41,580 SF**

**OCCUPANCY: GROUP B**

**SPRINKLER SYSTEM:**  
BUILDING IS SPRINKLED -

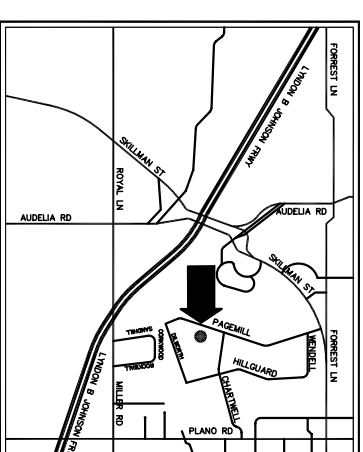

**LOCATION MAP**

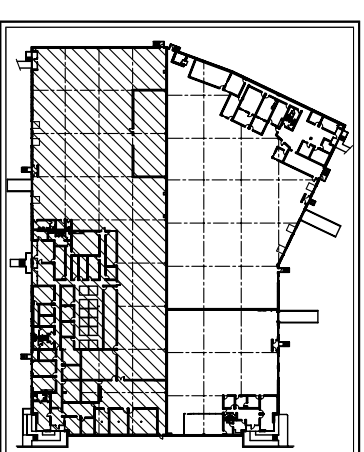

**KEY PLAN**

**11370 PAGEMILL  
DALLAS, TX**

**BUILDING SUMMARY**

OFFICE	11,746 SF
MANUFACTURING	4,306 SF
WAREHOUSE	25,528 SF
<b>TOTAL</b>	<b>41,580 SF</b>



5050 Quorum Drive Suite 400 Dallas, Texas 75254  
(972) 661-0232 Fax (972) 661-0235

Revised:				
----------	--	--	--	--

--	--

**GTS**  
PLANNERS

2914 Sportacus Drive  
Grand Prairie, TX 75052  
(972) 602-9041

Date:	Revised:	Sheet Number
03/12/09		
<b>9-032</b>		STONE