

**A REFLECTED CL'G PLAN**  
SCALE : 1/16" = 1'-0"

**CEILING NOTES:** ( NUMBERS IN HEXAGONS )

1. PROVIDE 2'x4' LAY-IN GRID CL'G AND TILE MTD 90" AFF - PROVIDE R-19 FG BATT INSULATION ABOVE ALL CL'G TILES - CL'G GRID AND TILE TO MATCH BLDG STD - CL'G GRID TO BE CONTINUOUS
2. 2'x4' LAY-IN FLUORESCENT FIXTURE W/ 3 T8 LAMPS, ELECTRONIC, HIGH FREQUENCY BALLAST, AND ACRYLIC LENS
3. SURFACE MTD, BATTERY POWERED, LED EXIT LIGHT
4. EXHAUST FAN, VENTED TO THE OUTSIDE, TO BE SWITCHED W/ THE LIGHT EXHAUST FAN TO PROVIDE A MINIMUM OF 75 CFM - TYP IN EACH RESTROOM
5. 2'x4' LAY-IN FLUORESCENT FIXTURE W/ 3 T8 LAMPS, ELECTRONIC, HIGH FREQUENCY BALLAST, AND ACRYLIC LENS ON NIGHT LIGHT CCT
6. PROVIDE NEW SWITCH LEGS FOR EXISTING LIGHT FIXTURES IN WAREHOUSE - ELECTRICAL CONTRACTOR TO DETERMINE EXACT NUMBER OF SWITCHES REQ'D RELAMP AND REBALLAST EXISTING WAREHOUSE LIGHTS AS REQ'D - ALL WAREHOUSE LIGHTS TO BE BURNING
7. EXISTING CL'G GRID AND LIGHTS TO REMAIN - PROVIDE NEW CL'G TILES W/ R-19 FG BATT INSULATION ABOVE - NEW CL'G TILE TO MATCH BLDG STD
8. EXISTING CL'G GRID TO REMAIN - PROVIDE NEW CL'G TILES TO MATCH BLDG STD

NOTE: SWITCHES IN ALL NEW ROOMS TO BE MOTION ACTIVATED EXCEPT IN RECEPTION AND MANUFACTURING AREAS

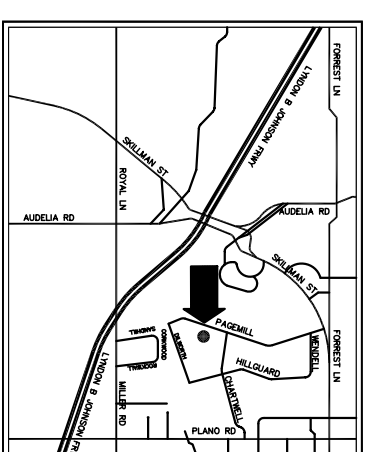

**LOCATION MAP**

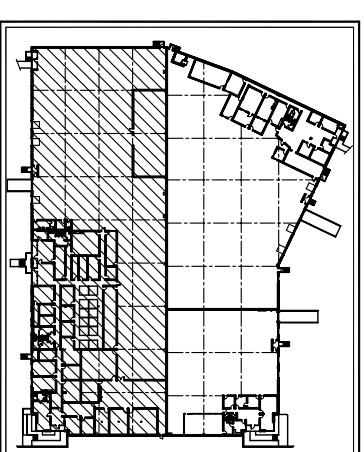

**KEY PLAN**

**11370 PAGEMILL  
DALLAS, TX**

| <b>BUILDING SUMMARY</b> |                  |
|-------------------------|------------------|
| OFFICE                  | 11,746 SF        |
| MANUFACTURING           | 4,306 SF         |
| WAREHOUSE               | 25,528 SF        |
| <b>TOTAL</b>            | <b>41,580 SF</b> |



5050 Quorum Drive Suite 400 Dallas, Texas 75254  
(972) 661-0232 Fax (972) 661-0235

| Revised: |  |  |  |  |
|----------|--|--|--|--|
|          |  |  |  |  |

|  |  |
|--|--|
|  |  |
|--|--|

**GTS PLANNERS**  
2914 Sportscous Dr  
Grand Prairie, TX 75092  
(972) 602-9041

|                   |           |                                |
|-------------------|-----------|--------------------------------|
| Date:<br>12/18/08 | Revision: | Sheet Number:<br><b>3 OF 3</b> |
| <b>9-032</b>      |           | STONE                          |